

2014 Wisconsin Amend Instructions for the TurboTax Online product:

- 1) To open your 2014 return, go to <https://turbotax.intuit.com> and sign in.
- 2) On the **Sign In** screen, enter your **User ID** and **Password** and select **Sign In**.
- 3) On the **Welcome home** screen, select **Taxes**.

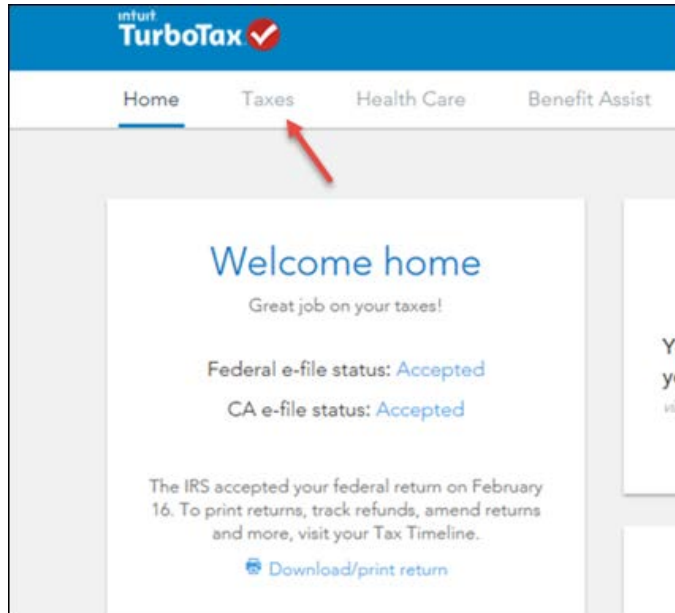

- 4) On the **Tax Timeline** screen, select **Amend (change) return**.

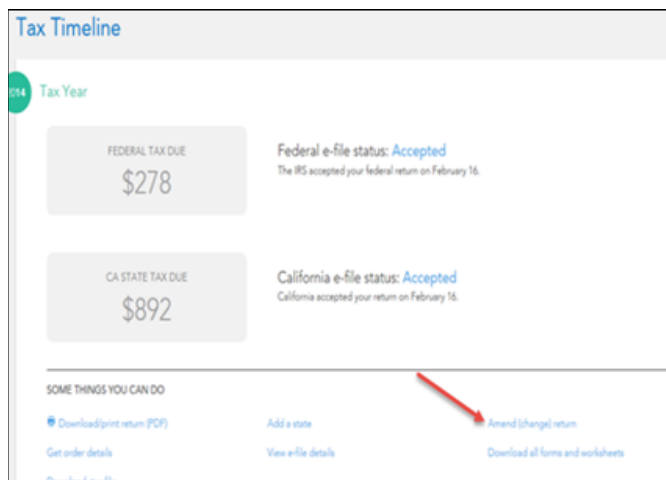

- 5) On the **Are you sure you'd like to amend your return?** screen, click the **Amend (change) return** button.

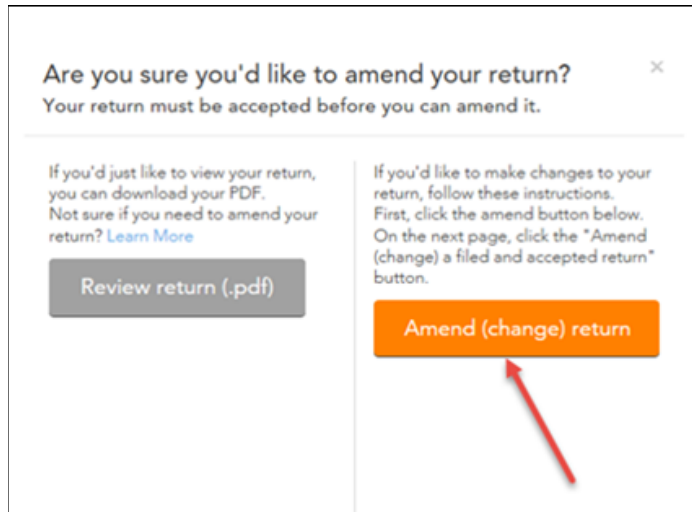

Start to Amend Your Return:

- 1) On the **We'll Help you change (amend) your return** screen, click **Continue**.

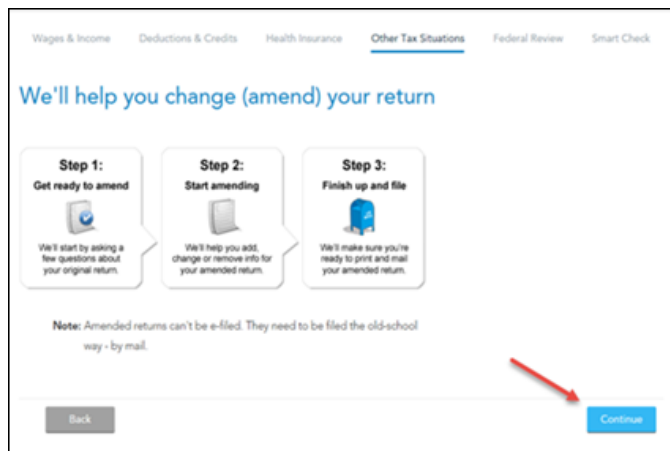

- 2) On the **Have You Already Filed This Return?** screen, select **Yes, I need to amend a return I already filed**.

Also select **I was contacted by TurboTax and told I may need to amend**, then click **Continue**.

- 3) On the **Tell Us Which Returns You Want to Amend** screen, select **I want to amend only my federal or only my state return**. Select **Amend my Wisconsin return**. Then select **Continue**.

- 4) On the **Do you still receive your mail at this address**, review the info and select **Continue**.

Wages & Income Deductions & Credits Health Insurance **Other Tax Situations** Federal Review Smart Check

Do you still receive your mail at this address?

Main Street
San Diego, CA
92108

Yes
 No

Back Continue

- 5) On the **Why did you need to amend your return?** Screen, indicate *“The original return included capital gain(s) that should not have been included in the original return. This amended reflects the accurate capital gains.”* Then select **Continue**.

Wages & Income Deductions & Credits Health Insurance **Other Tax Situations** Federal Review Smart Check

Why did you need to amend your return?

Enter a brief description of why you needed to change your original return.

Back Continue

- 6) On the **Let's review and get ready to file** screen, select **Continue** and complete all final review questions, if any. There may be additional questions to complete your state amended return.

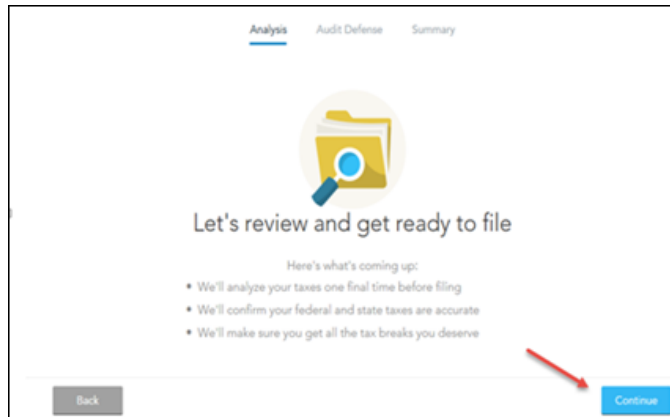

- 7) After you have completed your final review, select **Continue**.
- 8) You are now ready to print your return to file. On the **You're Done! Print and Mail Your Returns**, select **Print and Save Return**.

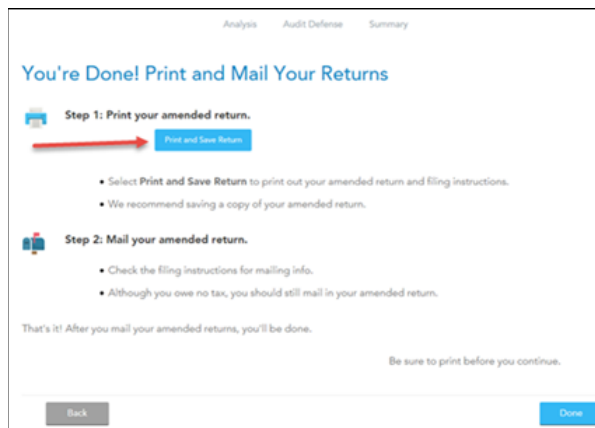

- 9) On the next screen, you will see a copy of the filing instructions for your amended return. Print out the filing instructions and the rest of the forms for your amended return.

John Smith
 123 Main Street
 San Diego, CA 92108

Balance Due/Refund	Your California state amended tax return shows no balance due or refund amount.
What You Need to Mail	Your amended tax return - 540X. Remember to sign and date the return. Attach the following to your California tax return: - any Form(s) W-2, W-2G, 592-B, 593, and 1099s that have California withholding you may have received to the front of your return. Mail your return and attachments to: Franchise Tax Board PO Box 942840 Sacramento, CA 94240-0001 Don't forget correct postage on the envelope.
What You Need to Keep	Keep these instructions and a copy of your return for your records. If you did not print one before closing TurboTax, go back to the program and select File tab, then select the Print for Your Records category.
2014 California	Adjusted Gross Income As Originally Filed Adjusted Gross Income Correct Amount \$ 50,000.00



10) After printing your return,

- The instruction letter will indicate any balance due that you need to pay or refund that you will receive.
- The instructions will also tell you the address to mail your return.
- Be sure to print out an extra copy to keep for your files.