

2016 Iowa Amend Instructions for the TurboTax Online product:

- 1) To open your 2016 return, go to <https://turbotax.intuit.com> and sign in.
- 2) On the **Sign In** screen, enter your **User ID** and **Password** and select **Sign In**.
- 3) On the **Welcome home** screen, select **My TurboTax**.

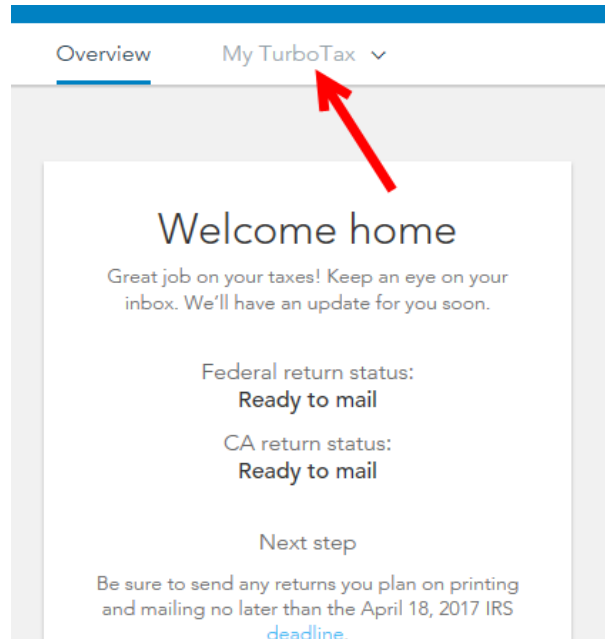

- 4) On the **Tax Timeline** screen, select **Amend (change) return**.

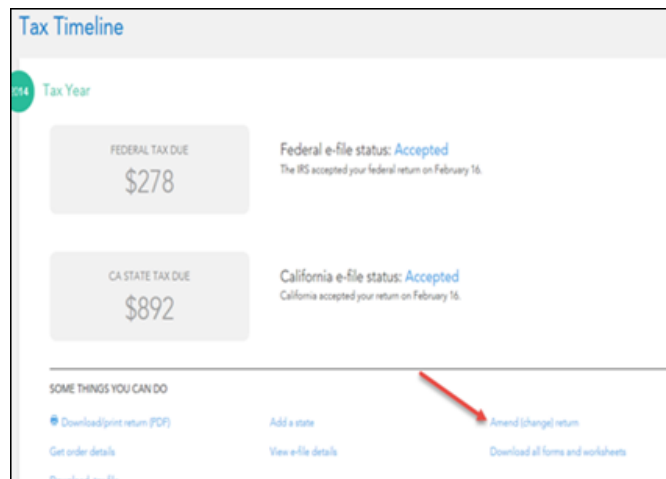

- 5) On the **Are you sure you'd like to amend your return?** screen, click the **Amend using TurboTax Online** button.

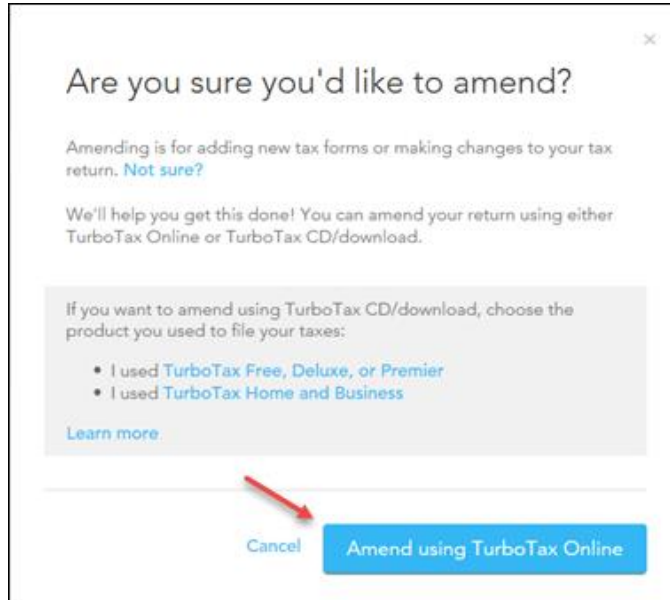

Start to Amend Your Return:

- 1) On the **We'll Help you change (amend) your return** screen, click **Continue**.

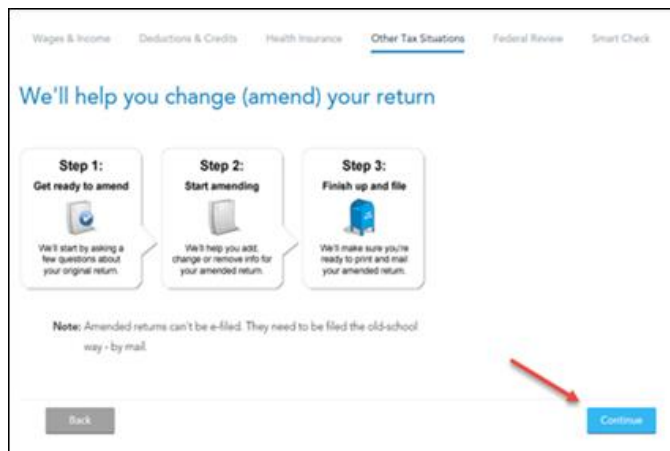

- 2) On the **Have You Already Filed This Return?** screen, select **Yes, I need to amend a return I already filed.**

Also select **I was contacted by TurboTax and told I may need to amend,** then click **Continue.**

Have you already filed this return?

Amending a return allows you to correct information on your original return after it's been filed and accepted by the government.

Yes, I need to amend a return I already filed.
 No, I don't need to amend.

Tell us a little more about your amend situation:

I need to amend my **2016** return. [Learn More](#)
 I need to amend a **2015** return.
 I need to amend a **2014 or previous year** return.
 I was contacted by TurboTax and told I may need to amend.
 I was contacted by TurboTax about amending **AND** I need to amend for some other reason. [See Examples](#)

< Back Continue

- 3) On the **Tell Us Which Returns You Want to Amend** screen, select **I want to amend only my federal or only my state return.** Select **Amend my Iowa return.** Then select **Continue.**

Tell Us Which Returns You Want to Amend

We recommend you amend both your **federal and state** returns. That's because both the IRS and your state will want to know why you amended your return.

I want to amend **both** my federal and state returns.
 I want to amend only my federal **or** only my state return.

[When is it OK to amend only one return?](#)

Are you sure you want to amend only one return?

We strongly recommend amending both your federal and state returns.

If you're sure about amending only one return, select the return you want to amend:

Amend my federal return
 Amend my Iowa return

< Back Continue

- 4) On the **Do you still receive your mail at this address,** make a selection then click **Continue.**

Do you still receive your mail at this address?

1 WILLOW RD
DES MOINES, IA
50301

Yes
 No

< Back Continue

5) If you see the **Presidential Election Campaign Fund** screen, make a selection then click **Continue**.

Presidential Election Campaign Fund

You can now make a \$3 contribution to the Presidential Election Fund on your amended return if you did not make an election when you filed originally.

Making a contribution does not impact your refund or any tax due.

Do you want to make a contribution?

Yes, I want to contribute
 No, I don't

< Back Continue

6) On the **Why did you need to amend your return?** screen, indicate **“The deduction for spouse’s federal withholding on certain income was erroneously deducted from the taxpayer’s net income. The revised return correctly reports the deduction for federal withholding and correctly calculates the amount of Iowa tax due.”** Then select **Continue**.

Why did you need to amend your return?

Enter a brief description of why you needed to change your original return.

The deduction for spouse's federal withholding on certain income was
erroneously deducted from the taxpayer's net income. The revised return
correctly reports the deduction for federal withholding and correctly calculates
the amount of lowa tax due.

< Back Continue

- 7) On the **Let's comb through your returns one last time with complete check** screen, select the **State Taxes** tab.

Personal Info Federal Taxes **State Taxes** Review File



Let's comb through your returns one last time with completecheck™

- We'll run a thorough, in-depth review of your federal and state taxes, from beginning to end.
- We'll go over your final refund so you can file with confidence.

Check my info

- 8) On the **Let's get your state taxes done right** screen, select **Continue**.



9) On the **Status of your state returns** screen, select **Edit** next to **Iowa**.

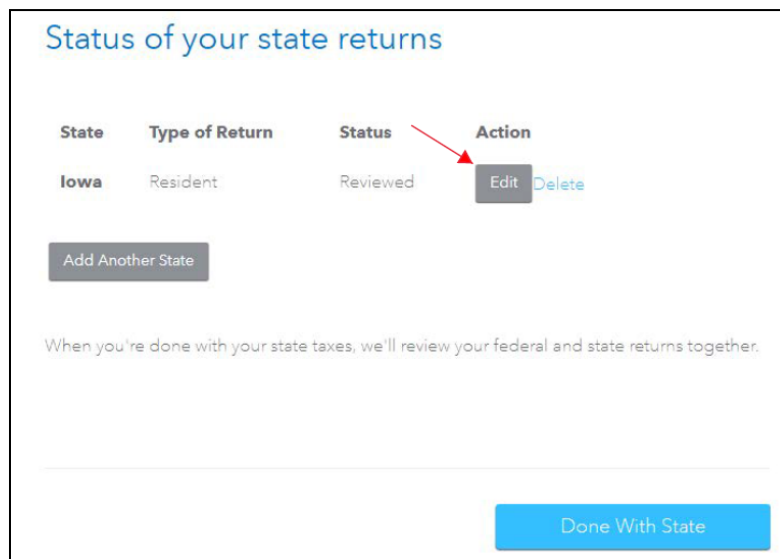

10) On the **Your 2016 Iowa Return** screen, select **Continue**.

Your 2016 Iowa Return

We're off to a great start! Now that we've transferred your federal info, a big part of your Iowa return is already done.

Next we'll walk you through the rest of your return, checking for:

- Iowa and federal tax law differences
- State-specific deductions and credits
- Any other situations we can help you with

Let's go ahead and wrap up your Iowa return.

Every year we track Iowa tax law changes. Find out [what's new](#) for 2016.

< Back Continue



11) On the **Let's Amend Your Iowa Return** screen, select **Yes, let's amend and get it done**. Then select **Continue**.

Let's Amend Your Iowa Return

We're all set to start amending your Iowa return.



Are you ready to amend your Iowa return now?

Yes, let's amend and get it done (Recommended)

No, I'll amend later

I don't need to amend my state return after all

< Back Continue



- 12) On the **Amount Paid on Original Return** screen, enter the **amount of tax paid** with or after filing your **original** 2016 Iowa tax Return. This amount can be found on Line 73 of the Iowa 1040. Then, select **Continue**.

Amount Paid on Original Return

Enter the **amount of tax paid** with or after filing your **original** 2016 Iowa tax return. **Do not** include any penalties or interest paid. This amount is on Line 73 of the Iowa 1040 (if none, enter zero.)

Amount Paid on Original Return

< Back Continue

- 13) On the **Overpayment on Original Return** screen, enter the **overpayment**, if any, claimed or adjusted on your **original** 2016 Iowa tax return. This amount can be found on Line 70 of the Iowa 1040. Then, select **Continue**.

Overpayment on Original Return

Enter the **overpayment**, if any, claimed or adjusted on your **original** 2016 Iowa tax return. This amount was on Line 70 of the Iowa 1040. (if none, enter zero.)

Overpayment as Shown on Original Return

< Back Continue

- 14) On the **Reason for Amending Original Return**, check the box next to **Other Correction**. Also check the box next to **Transfer federal amended explanation to Iowa**. Then, select **Continue**.

Reason for Amending Original Return

Indicate the reason(s) for **amending** your Iowa tax return. Check any that apply.

- Federal Audit
- Net Operating Loss
- Protective Claim
- Other Correction
- Transfer federal amended explanation to Iowa

[< Back](#) [Continue](#)

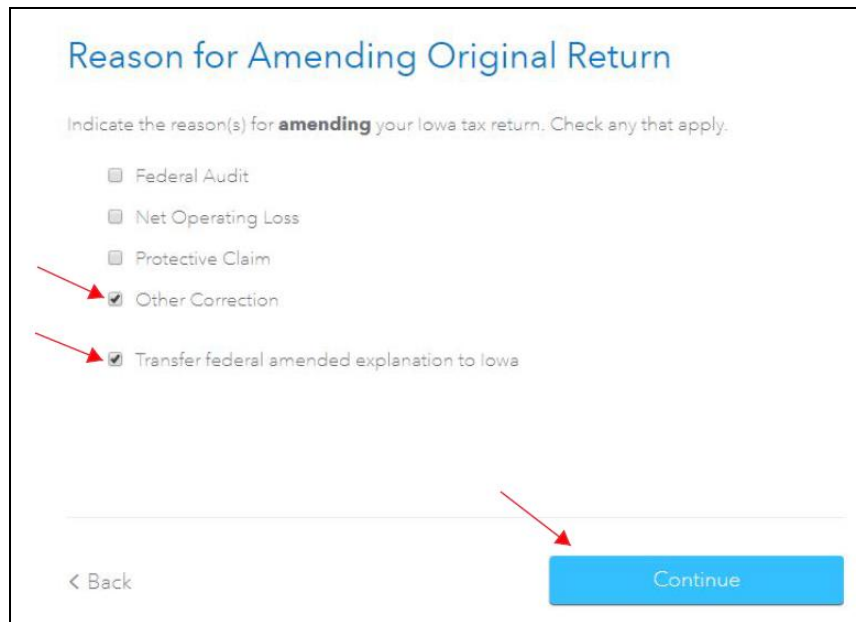

15) On the **About Your Iowa Amended Return** screen, make any additional necessary changes. Ensure that the federal explanation has transferred to the Iowa return, then, select **Continue**.

About Your Iowa Amended Return

Use Form IA 1040X below to correct an error on a previously filed return. Complete this form only **after** you have filed the original return.

If you filed a form to amend your federal return, you must also file a form to amend your Iowa return, unless the changes do not affect your state taxes.

changes. Please indicate how the change in income, deductions, or credits are allocated between spouses.

Check this box to transfer the federal explanation from the Federal amended form

be aware that the federal and state tax forms may have different line numbers and page references, and please make changes accordingly.

Deduction for spouse's federal withholding on certain income was
erroneously deducted from the taxpayer's net income. The revised return
correctly reports the deduction for federal withholding and correctly calculates
the amount of Iowa tax due.

Explanation of Social Security and Pension Exclusion changes

< Back

Continue

- 16) On the **Let's Make Sure You're Ready to Review** screen, select **Yes, I've entered everything and let's review**. Then, select **Continue** complete any additional final review questions.

Let's Make Sure You're Ready to Review

 So far so good! We've now covered the main part of your Iowa amended return. Unless you have additional state amend info to enter, we're ready to move on and review.

Have you entered all of your state amend info?

Yes, I've entered everything and let's review

 No, I still have state amend info to enter [How would I know this?](#)

< Back
Continue

17) On the **Status of your state returns** screen, select **Done With State**.

Status of your state returns

State	Type of Return	Status	Action
Iowa	Resident	Reviewed	Edit

Add Another State

When you're done with your state taxes, we'll review your federal and state returns together.

Done With State

18) On the **Let's comb through your returns one last with complete check** screen, select **Check my info** and complete all final review questions, if any.

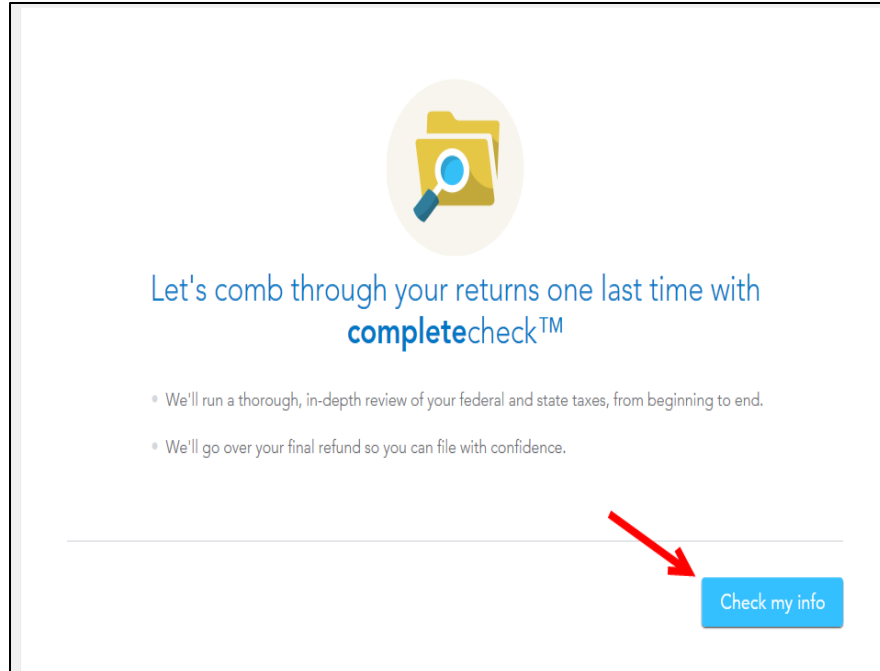

19) On the **You're just about ready to file. But first...** screen, select **Continue**.

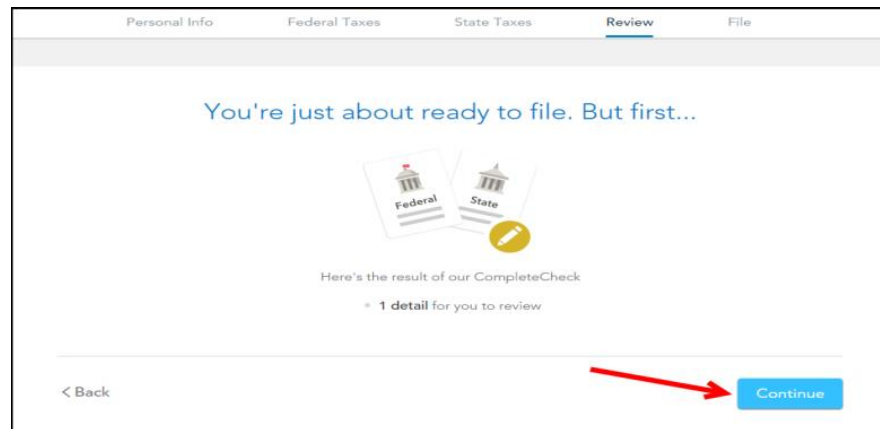

20) On the **Let's take care of these details now** screen, select **Review**

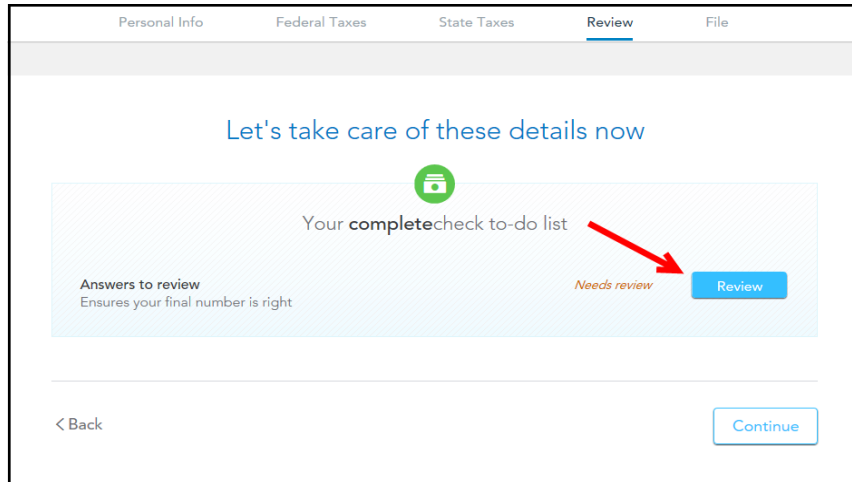

21) On the **Here are the results of our final review** screen, select **Fix Iowa Return**.

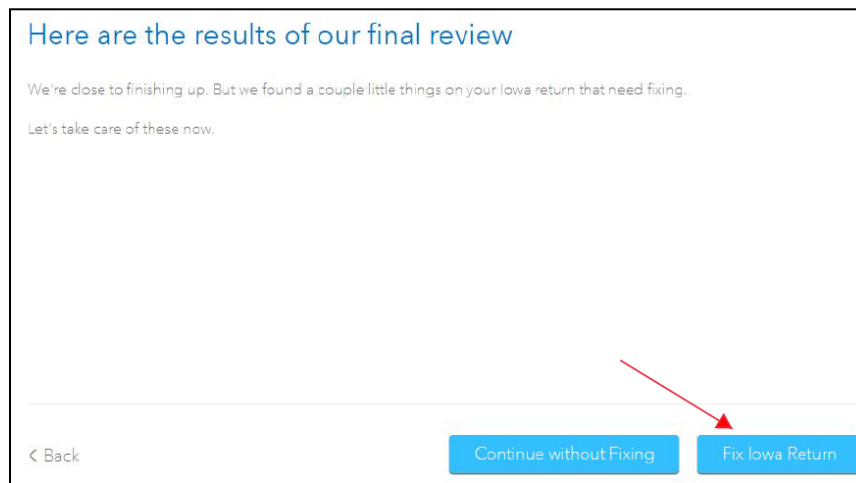

22) On the **Not Eligible for Electronic Filing** screen, select **Continue**.

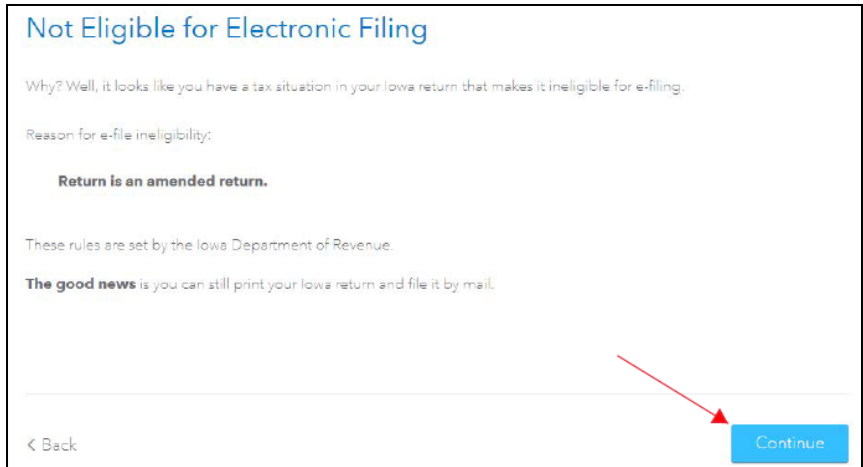

23) On the **Let's take care of these details now** screen, select **Review**. On the **Here are the results of our final review** screen, select **Fix Iowa Return**. If there are any remaining errors, make necessary changes. The **Not Eligible for Electronic Filing** error will **NOT** go away. Once you have fixed any remaining errors, select **Continue**.

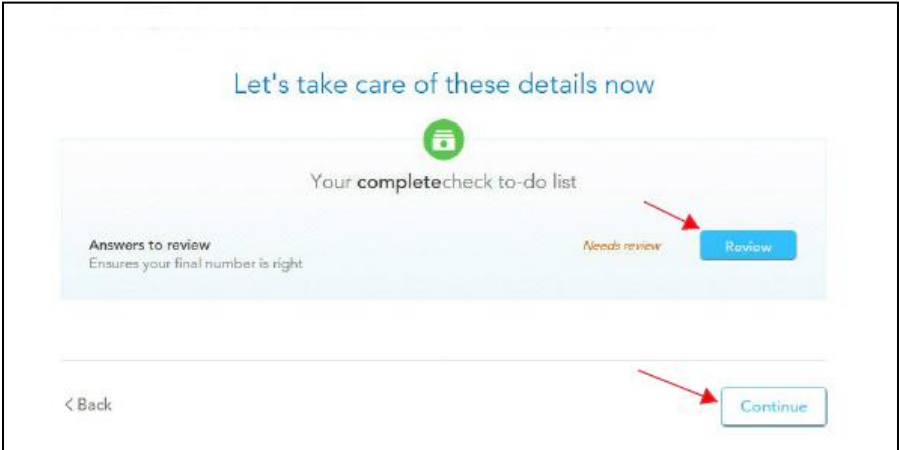

24) On the **We still have a couple details to button up** screen, select **Continue**.

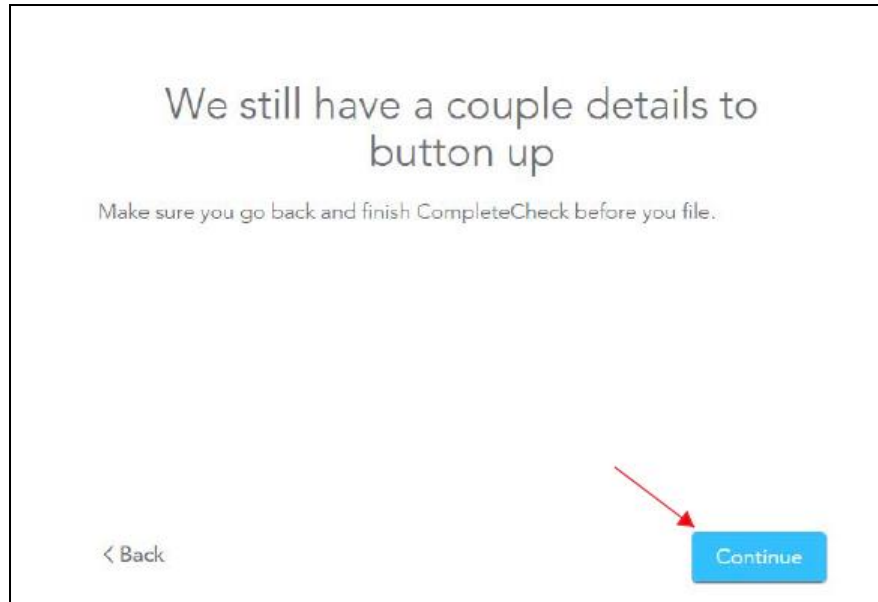

25) You are now ready to print your return to file. On the **You're Done! Print and Mail Your Returns** screen, select **Print Return**.

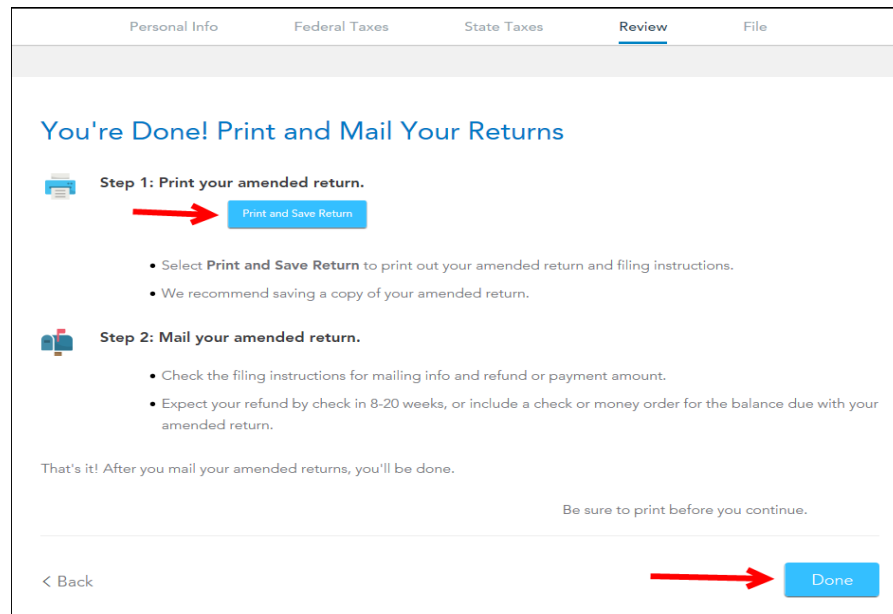

26) On the **Print Preview** screen, select the **Printer Icon** to print your forms.

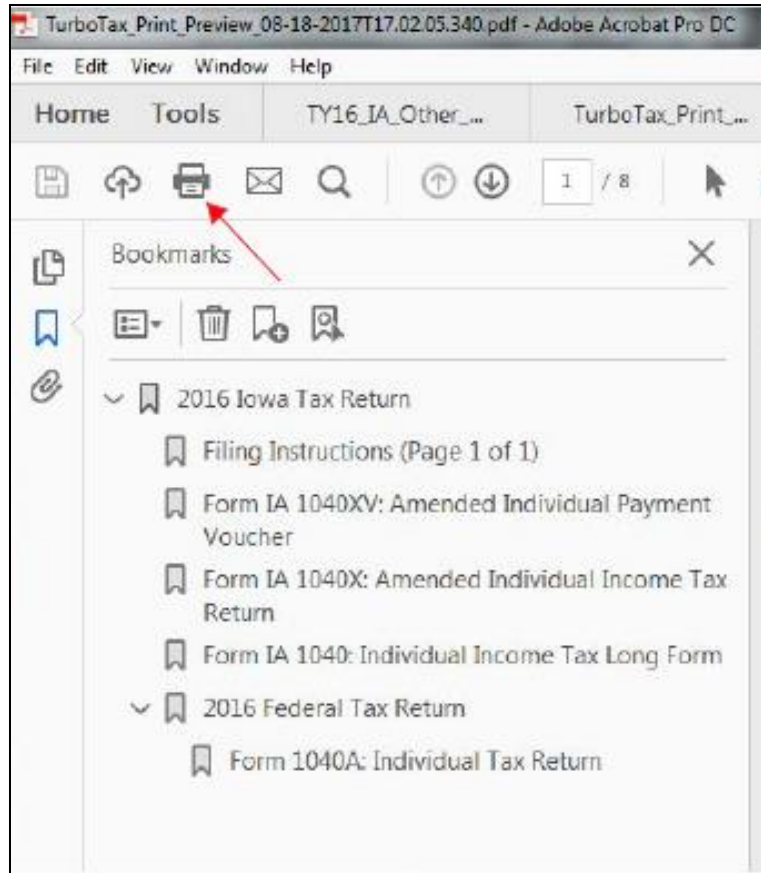

27) After printing your return,

- The instruction letter will indicate any balance due that you need to pay or refund that you will receive.
- The instructions will also tell you the address to mail your return.
- Be sure to print out an extra copy to keep for your files.