

2016 Iowa Cancelled Debt Principal Residence Amend Instructions for Online:

- 1) To open your 2016 return, go to <https://turbotax.intuit.com> and sign in.
- 2) On the **Sign In** screen, enter your **User ID** and **Password** and select **Sign In**.
- 3) On the **Welcome home** screen, select **My TurboTax**.

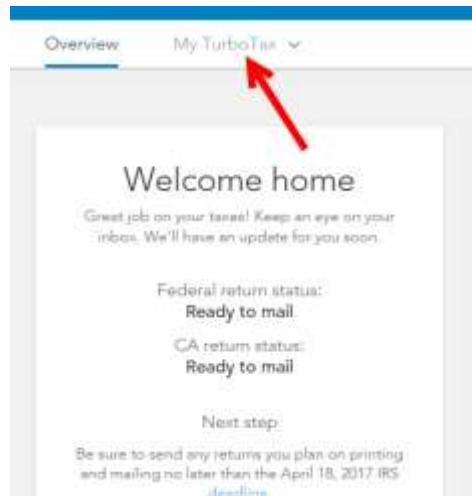

- 4) On the **Tax Timeline** screen, select **Amend (change) return**.

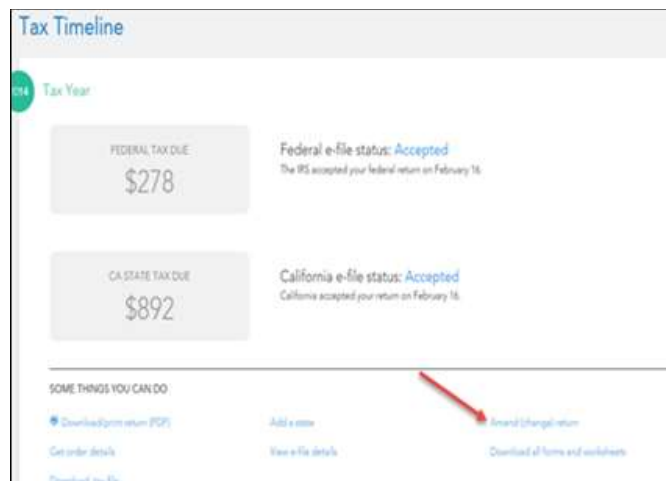

- 5) On the **Are you sure you'd like to amend your return?** screen, click the **Amend using TurboTax Online** button.

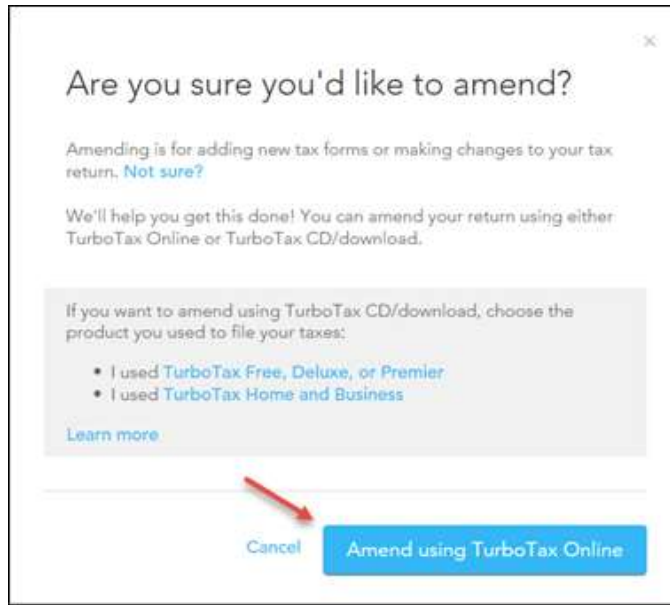

Start to Amend Your Return:

- 1) On the **We'll Help you change (amend) your return** screen, click **Continue**.

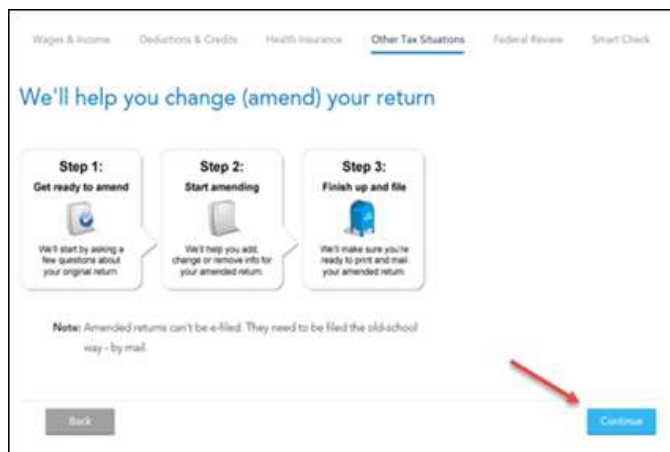

- 2) On the **Have You Already Filed This Return?** screen, select **Yes, I need to amend a return I already filed**.

Also select **I was contacted by TurboTax and told I may need to amend**, then click **Continue**.

Have you already filed this return?

Amending a return allows you to correct information on your original return after it's been filed and accepted by the government.

Yes, I need to amend a return I already filed.

No, I don't need to amend.

Tell us a little more about your amend situation:

I need to amend my 2016 return. [Learn More](#)

I need to amend a 2015 return.

I need to amend a 2014 or previous year return.

I was contacted by TurboTax and told I may need to amend.

I was contacted by TurboTax about amending AND I need to amend for some other reason. [See Example](#)

[Back](#) [Continue](#)

- 3) On the **Tell Us Which Returns You Want to Amend** screen, select **I want to amend only my federal or only my state return**. Select **Amend my Iowa return**. Then select **Continue**.

Personal Info **Federal Taxes** State Taxes Review File

Wages & Income Deductions & Credits Health Insurance **Other Tax Situations** Federal Review

Tell Us Which Returns You Want to Amend

We recommend you amend both your **federal and state** returns. That's because both the IRS and your state will want to know why you amended your return.

I want to amend **both** my federal and state returns.

I want to amend **only my federal or only my state** return.

[When is it OK to amend only one return?](#)

Are you sure you want to amend only one return?

We strongly recommend amending both your federal and state returns.

If you're sure about amending only one return, select the return you want to amend:

Amend my federal return

Amend my Iowa return

[Back](#) [Continue](#)

- 4) On the **Do you still receive your mail at this address**, make a selection then click **Continue**.

Wages & Income Deductions & Credits Health Insurance **Other Tax Situations** Federal Returns

Do you still receive your mail at this address?

123 Main Street
Jackson, IN
50001

Yes

No

< Back Continue

- 5) If you see the **Presidential Election Campaign Fund** screen, make a selection then click **Continue**.

Presidential Election Campaign Fund

You can now make a \$3 contribution to the Presidential Election Fund on your amended return if you did not make an election when you filed originally.

Making a contribution does not impact your refund or any tax due.

Do you want to make a contribution?

Yes, I want to contribute

No, I don't

< Back Continue

- 6) On the **Why did you need to amend your return?** screen, indicate **“The originally filed Iowa tax return incorrectly included net investment income tax on Line 32 as part of federal estimated tax payments made in 2016. The adjustment to the Iowa return reflects the correct amount of estimated tax payments and tax due for the state return.”** Then select **Continue**.

Why did you need to amend your return?

Enter a brief description of why you needed to change your original return.

Back Continue

- 7) On the **Let's comb through your returns one last time with complete check** screen, select **Check my info** and complete all final review questions, if any.

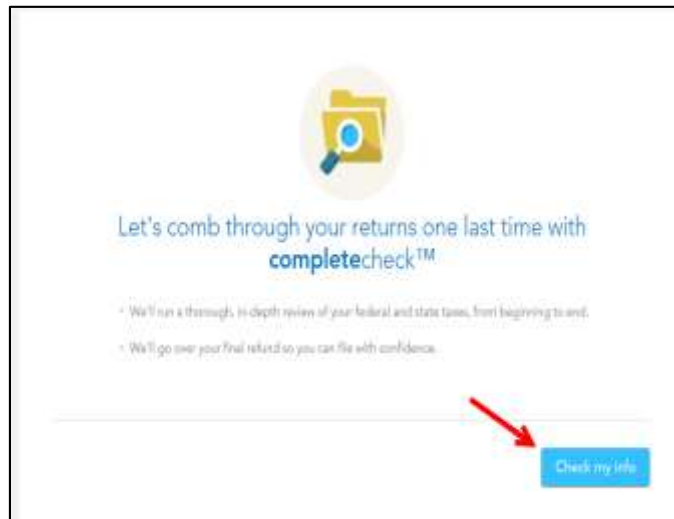

Note: At this point, if the IA refund box at the top of your screen says \$0, proceed to Step 15. If it shows an amount due, proceed to Step 8.

- 8) On the **You're just about ready to file. But first...** screen, select **Continue**.

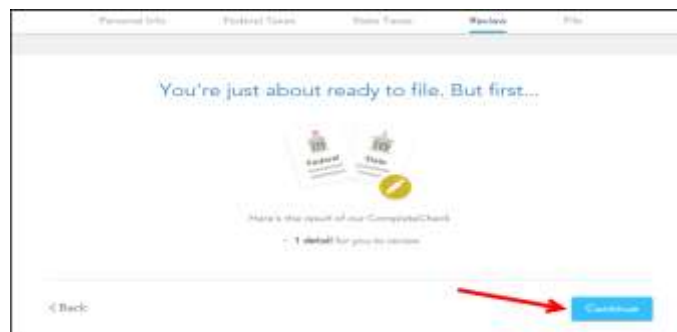

- 9) On the **Let's take care of these details now** screen, select **Review**

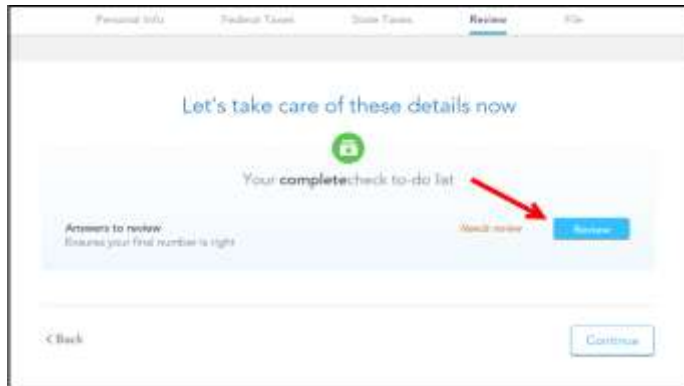

10) On the **Here are the results of our final review** screen, select **Fix Iowa Return**.

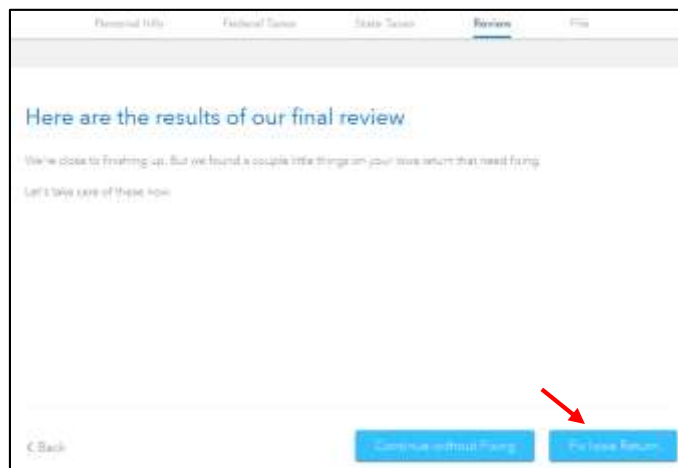

11) On the **We still have a couple details to button up** screen, select **Continue**.

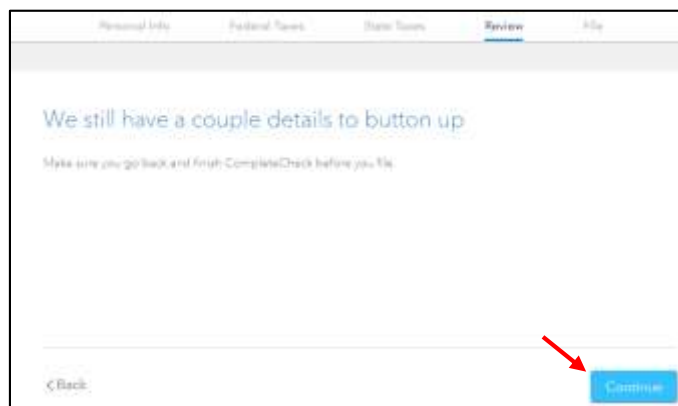

12) You are now ready to print your return to file. On the **You're Done! Print and Mail Your Returns** screen, select **Print Return**.

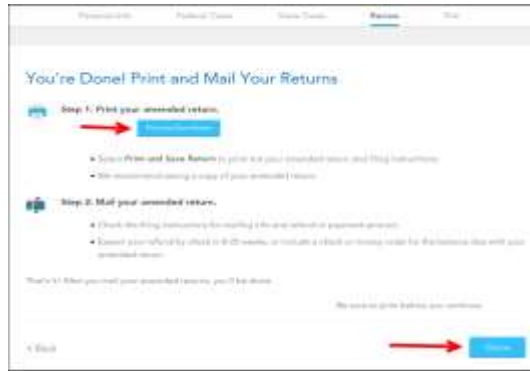

13) On the **Print Preview** screen, select the **Printer Icon** to print your forms.

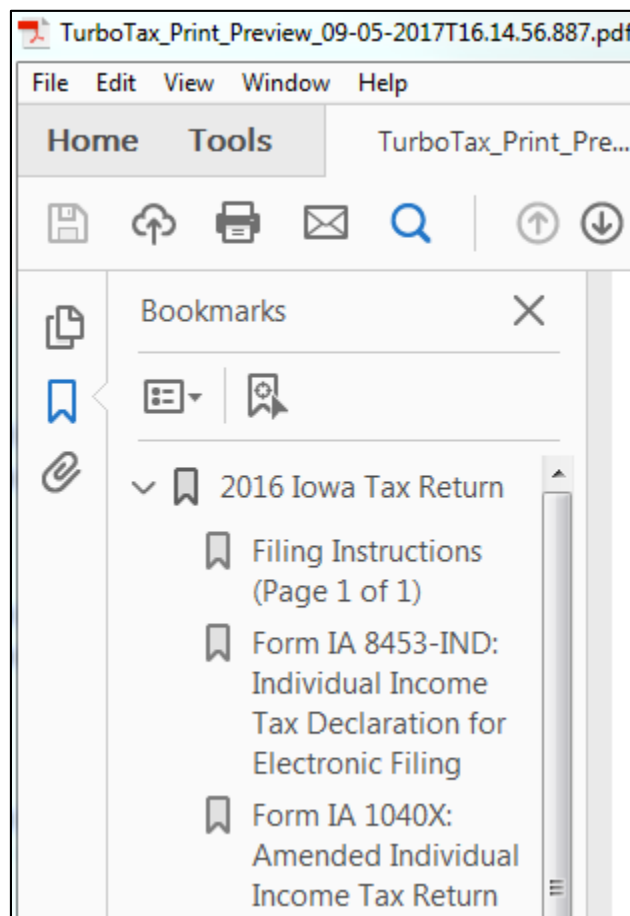

14) After printing your return,

- The instruction letter will indicate any balance due that you need to pay or refund that you will receive.
- The instructions will also tell you the address to mail your return.

- Be sure to print out an extra copy to keep for your files

Note: At this point you are done – you do not need to proceed with any further steps.

- 15) On the **Let's comb through your returns one last time with complete check** screen, select the **State Taxes** tab.

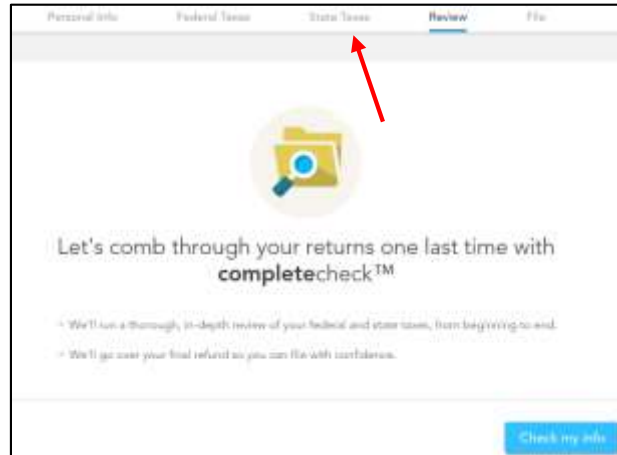

- 16) On the **Let's get your state taxes done right** screen, select **Continue**.

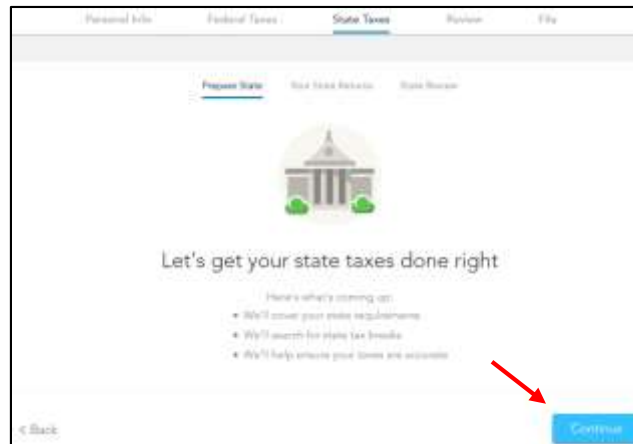

- 17) On the **Status of your state returns screen**, choose **Continue (or Edit)** next to the **Iowa state tax return**.

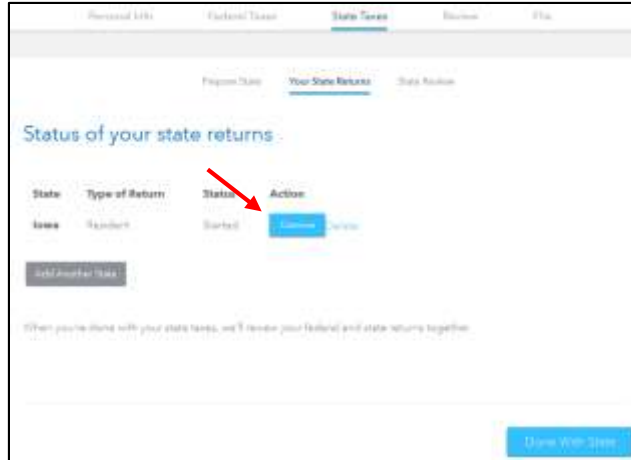

18) On the **Your 2016 Iowa Return** screen, select **Continue**.

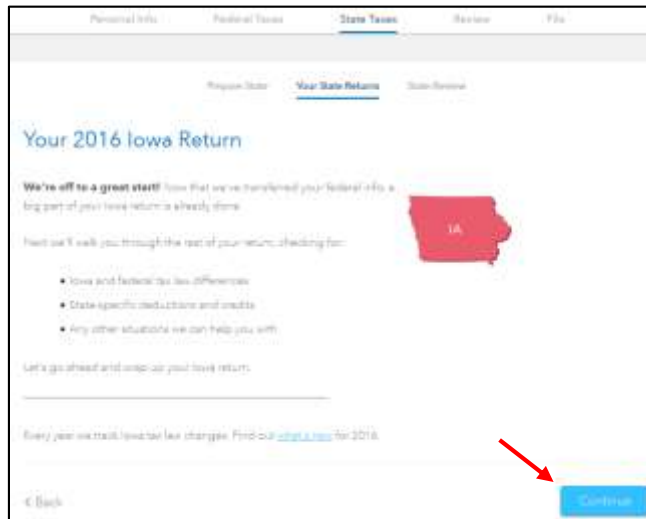

19) On the **Let's Amend Your Iowa Return** screen, select **Yes, let's amend and get it done**. Then click **Continue**.

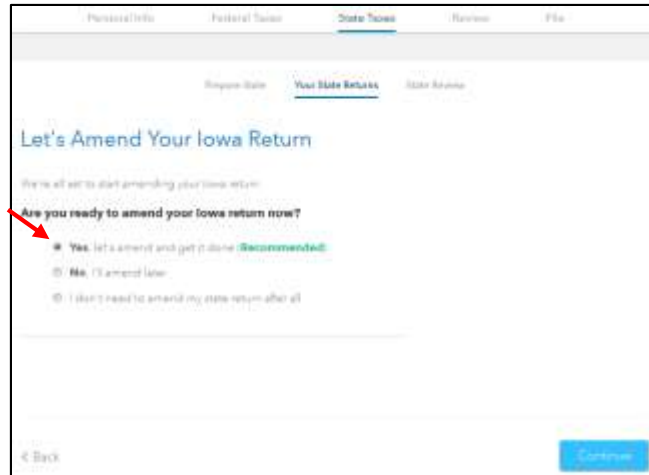

- 20) On the **Amount Paid on Original Return** screen, make sure the amount shown is correct. If it is not, delete it and enter the correct amount of tax paid with the original Iowa return. If you received a refund with your original return, enter a 0 in this box. You will enter the refund on the next screen. Then click **Continue**.

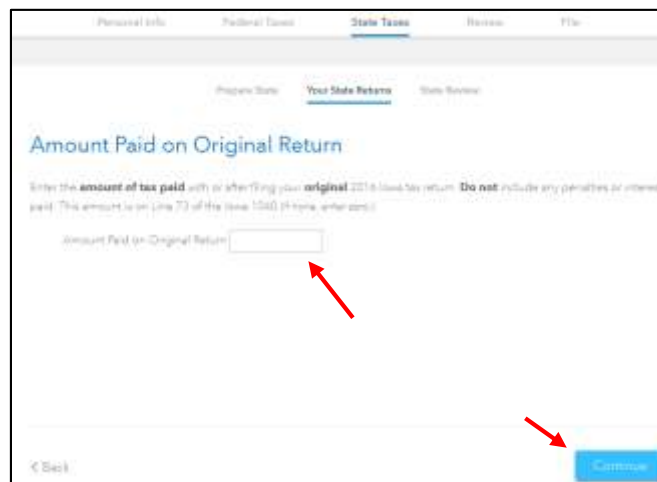

- 21) On the **Overpayment on Original Return** screen, make sure the amount shown is correct. If it is not, delete it and enter the correct amount of the refund received with the original Iowa return. (Note: If you owed money with your original Iowa return you may not see this screen and may skip this step).

22) On the **Reason for Amending Original Return** screen, check **Other Correction**. Also check **Transfer federal amended explanation to Iowa** (if not already selected). Then select **Continue**.

23) On the **About Your Iowa Amended Return** screen, select **Continue**.

24) On the **Let's Make Sure You're Ready to Review** screen, select **Yes, I've entered everything and let's review** and click **Continue**.

25) On the **Ready to Review Your State Tax Return** screen, select **Continue**.

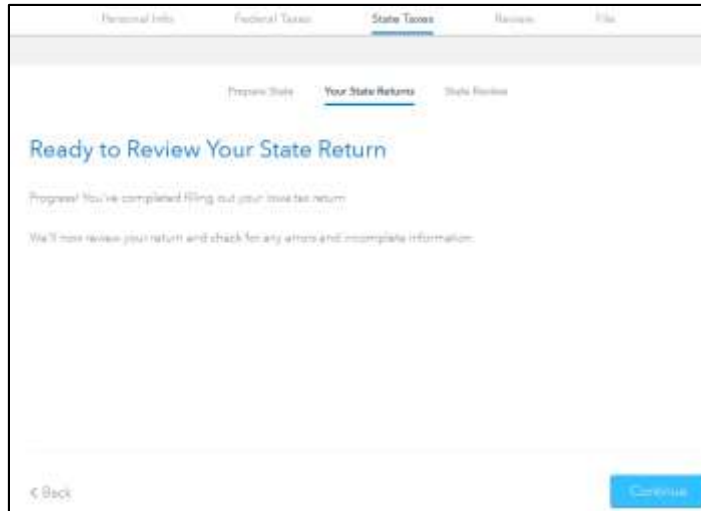

26) On the **Let's make sure everything is accurate** screen, select **Fix Return**.

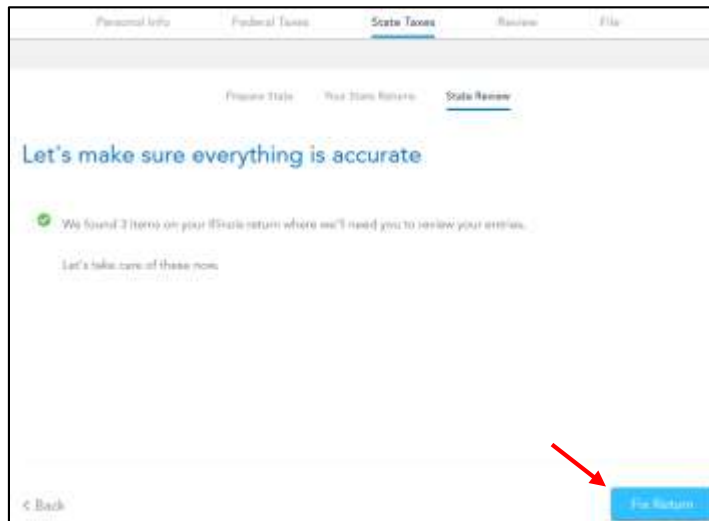

Note: From this point, you will pick back up with instruction #8 and continue to print your amended return.